

PLASMA TORCHES

SC120 Plasma Torch

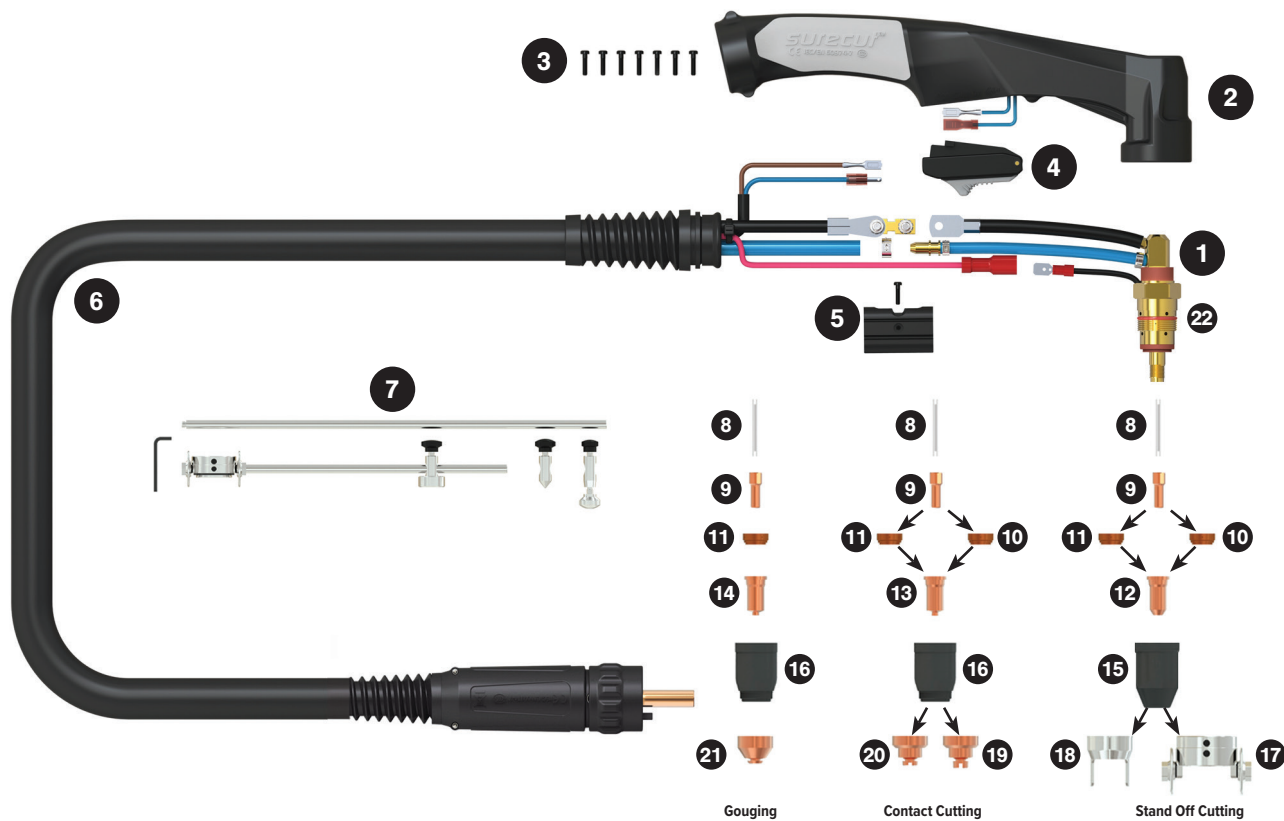

Length	6m
SKU	WG-SC120-60-CC1

TORCH SPARES		
1	SC1201	SC120 Torch Head Kit
2	SC8014	Plasma Handle Kit
3	SCSP1	Screw Pack
4	SC2516	Plasma Safety Trigger
5	SC8015	Location Block
6	SC8019-60-CF4	Cable Assembly Complete X 6mt
7	SC1250	Circle Cutting Attachment Kit
8	SC1202	Cooling Tube
9	PSC1204	Electrode
10	SC1207	Swirl Ring
11	SC1206	Swirl Ring - Heavy Duty
12	PSC1220-10	Cutting Tip 1.0mm 40-50A
	PSC1220-11	Cutting Tip 1.1mm 50-60A
	PSC1220-12	Cutting Tip 1.2mm 60-70A
	PSC1221-14	Cutting Tip 1.4mm 80-90A
	PSC1221-15	Cutting Tip 1.5mm 100-110A
	PSC1221-16	Cutting Tip 1.6mm 110-120A
13	PSC1226-10	Contact Cutting Tip 1.0mm 40-50A
	PSC1226-11	Contact Cutting Tip 1.1mm 50-60A
	PSC1226-12	Contact Cutting Tip 1.2mm 60-70A
	PSC1227-14	Contact Cutting Tip 1.4mm 80-90A
	PSC1227-15	Contact Cutting Tip 1.5mm 100-110A
	PSC1227-16	Contact Cutting Tip 1.6mm 110-120A
	PSC8026-13	Cutting Tip Contact 1.3mm
14	SC1228-22	Gouging Tip 2.2mm
15	SC1230	Retaining Cap 30-70A
	SC1231	Retaining Cap 80-120A

TORCH SPARES		
16	SC1232	Shield Cap Body
17	SC1251	Cutting Buggy
18	SC1240	Stand-off Guide
19	SC8041	Shield Cap
20	SC1241	Shield Cap
21	SC8043	Shield Cap Gouging
22	SC1208	O Ring

TECHNICAL DATA	
COOLING METHOD	Air Cooled
DUTY CYCLE	60% @ 120A
CUTTING THICKNESS	20-25mm
GAS	Air/N2
GAS PRESSURE	4.5-5.0 Bar / 65-75 psi
GAS FLOW	110L/min
IGNITION	Pilot Arc
POST FLOW	90s
LENGTHS (m)	6
STANDARD	EN60974-7

MACHINES

SAFETY

GAS EQUIPMENT

TORCHES

ACCESSORIES

FILLER METALS