

# MINI SPIDER

## FILLET WELDING CARRIAGE

### Overview

The Trademaster Mini Spider is a battery-powered welding tractor designed to produce continuous fillet welds using MIG/MAG torches. The torch can be easily swapped from one side of Mini Spider to another.

4-wheel drive system with magnetic traction and a feedback loop provides highly efficient speed stabilization. Constant, continuous and repeatable travel speed enables weld bead geometry that is exact to the required specifications, thus reducing costly over welding and substantially decreasing filler metal usage. An optional power supply can be used to plug the carriage into a 110–240 V power source.

### Features

- Compact and lightweight design to weld in narrow spaces
- Convenient 18 V DC battery supply
- (the same battery for both Mini Spider and Gecko Battery)
- Torch placement on either side
- Welding edge to edge
- Closed-loop speed control system based on electric motor with encoder - ensures increased speed accuracy
- Consistent heat input reduces distortion
- Reduces wasted filler metal - eliminates over welding
- Digital LED display for presetting of travel speed and diagnostic messages
- Low-battery indicator
- Built-in guide rolls

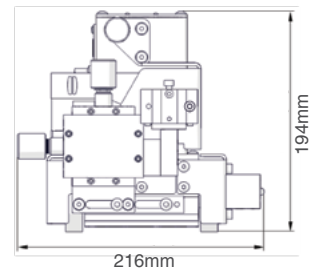
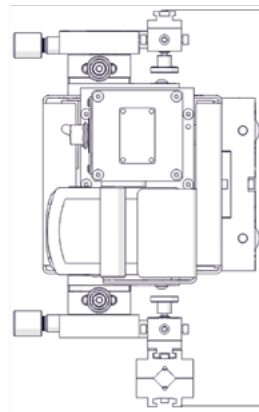

Part No.	<b>MINISPIDER</b>
Voltage	18 V DC, 5.2 Ah, 1~ 110–240 V, 50–60 Hz (option)
Power	25W
Welding position (according to EN ISO 6947 and AWS/ASME)	PB / 2F, PD / 4F
Torch diameter	16-22mm
Minimum workpiece thickness	4mm
Ground clearance	4mm
Horizontal pulling force	150N
Vertical pulling force	100N
Horizontal speed *	0–110 cm/min
Vertical speed *	0–100 cm/min
Weight (w/o battery)	7.6kg

\* With battery fully charged

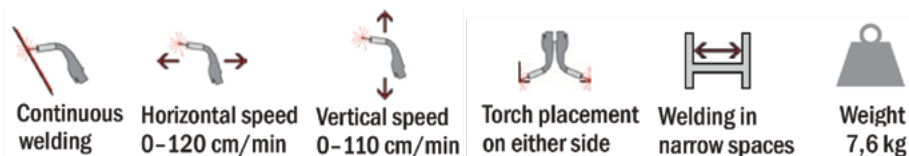

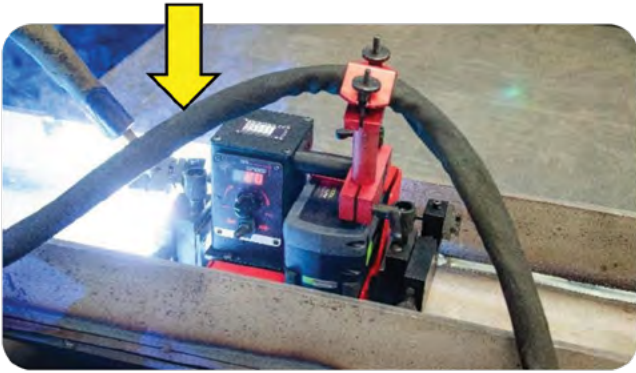

Torch placement on either side

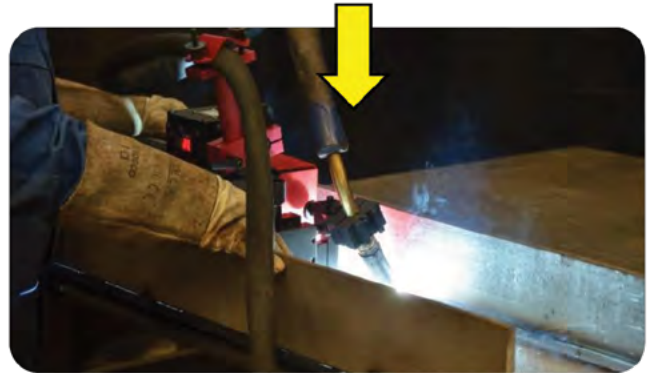

Welding edge to edge



Welding in narrow spaces

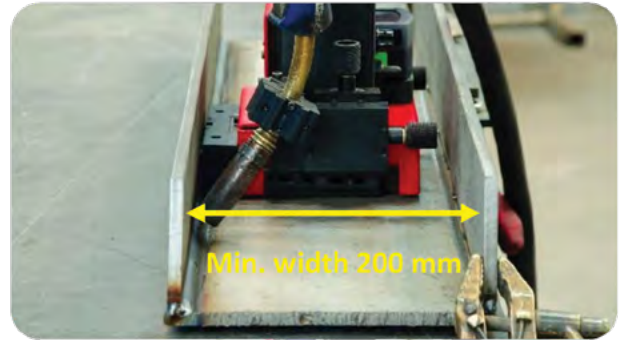

Optional 110 - 240V power supply