

Union Elbows

Union Elbows

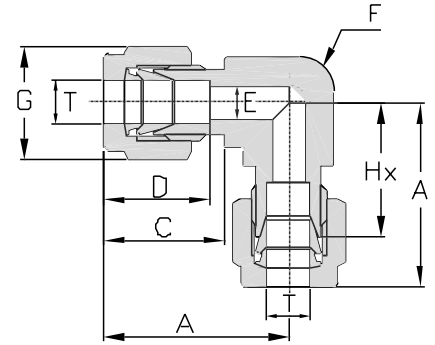

ENGLISH UNITS

Model Number	T Tube O.D. in.	A in.	C in.	D in.	E in.	F Hex Flat in.	G Hex Flat in.	H in.
SS-UE-TF2	1/8	0.88	0.60	0.50	0.09	3/8	7/16	0.62
SS-UE-TF3	3/16*	1.00	0.63	0.54	0.12	1/2	1/2	0.74
SS-UE-TF4	1/4	1.06	0.70	0.60	0.19	1/2	9/16	0.77
SS-UE-TF5	5/16*	1.13	0.73	0.64	0.25	9/16	5/8	0.84
SS-UE-TF6	3/8	1.20	0.76	0.66	0.28	5/8	11/16	0.91
SS-UE-TF8	1/2	1.42	0.86	0.90	0.41	13/16	7/8	1.02
SS-UE-TF10	5/8*	1.50	0.86	0.96	0.50	15/16	1	1.10
SS-UE-TF12	3/4	1.57	0.86	0.96	0.62	1-1/16	1-1/8	1.17
SS-UE-TF16	1	1.93	1.04	1.23	0.88	1-3/8	1-1/2	1.45

METRIC UNITS

Model Number	T Tube O.D. mm	A mm	C mm	D mm	E mm	F Hex Flat mm	G Hex Flat mm	H mm
SS-UE-TF3M	3	22.3	15.3	12.9	2.4	9.50	12	15.7
SS-UE-TF6M	6	27.0	17.7	15.3	4.8	12.7	14	19.6
SS-UE-TF8M	8	28.8	18.8	16.2	6.4	16.0	16	21.3
SS-UE-TF10M	10	31.5	19.5	17.2	7.9	20.5	19	23.9
SS-UE-TF12M	12	36.0	22.0	22.8	9.5	20.5	22	25.9
SS-UE-TF14M	14	38.0	22.0	24.4	11.1	23.8	25	27.9
SS-UE-TF16M	16*	38.0	22.0	24.4	12.7	23.8	25	27.9
SS-UE-TF18M	18*	39.8	22.0	24.4	15.1	27	30	29.7
SS-UE-TF22M	22*	44.6	22.0	26.0	18.3	35	32	34.5
SS-UE-TF25M	25*	49.1	26.5	31.3	21.8	35	38	36.8

*: Consult factory