

Male Elbows

GENLOK to Male NPT Thread Elbow

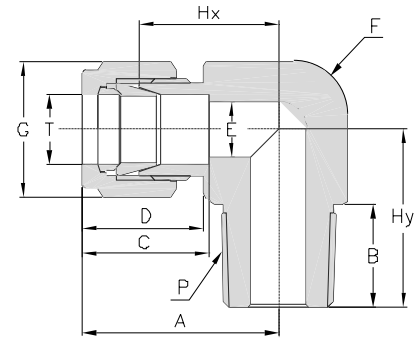

ENGLISH UNITS

Model Number	T Tube O.D. in.	P NPT Male Pipe Size in.	A in.	B in.	C in.	D in.	E in.	F Hex Flat in.	G Hex Flat in.	Hx in.	Hy in.
SS-ME-TF2-NT2	1/8	1/8	0.93	0.38	0.60	0.50	0.09	7/16	7/16	0.67	0.70
SS-ME-TF2-NT4	1/8	1/4	0.97	0.56	0.60	0.50	0.09	1/2	7/16	0.71	0.92
SS-ME-TF3-NT2	3/16*	1/8	1.00	0.38	0.63	0.54	0.12	1/2	1/2	0.74	0.74
SS-ME-TF3-NT4	3/16*	1/4	1.00	0.56	0.63	0.54	0.12	1/2	1/2	0.74	0.92
SS-ME-TF4-NT2	1/4	1/8	1.06	0.38	0.70	0.60	0.19	1/2	9/16	0.77	0.74
SS-ME-TF4-NT4	1/4	1/4	1.06	0.56	0.70	0.60	0.19	1/2	9/16	0.77	0.92
SS-ME-TF4-NT6	1/4	3/8	1.17	0.56	0.70	0.60	0.19	11/16	9/16	0.88	1.03
SS-ME-TF4-NT8	1/4	1/2	1.25	0.75	0.70	0.60	0.19	13/16	9/16	0.96	1.30
SS-ME-TF5-NT2	5/16*	1/8	1.13	0.38	0.73	0.64	0.19	9/16	5/8	0.84	0.78
SS-ME-TF5-NT4	5/16*	1/4	1.13	0.56	0.73	0.64	0.25	9/16	5/8	0.84	0.96
SS-ME-TF5-NT6	5/16*	3/8	1.20	0.56	0.73	0.64	0.25	11/16	5/8	0.91	1.03
SS-ME-TF6-NT2	3/8	1/8	1.20	0.38	0.76	0.66	0.19	5/8	11/16	0.91	0.82
SS-ME-TF6-NT4	3/8	1/4	1.20	0.56	0.76	0.66	0.28	5/8	11/16	0.91	1.00
SS-ME-TF6-NT6	3/8	3/8	1.23	0.56	0.76	0.66	0.28	11/16	11/16	0.94	1.03
SS-ME-TF6-NT8	3/8	1/2	1.31	0.75	0.76	0.66	0.28	13/16	11/16	1.02	1.30
SS-ME-TF6-NT12	3/8	3/4	1.46	0.75	0.76	0.66	0.28	1-1/16	11/16	1.17	1.45
SS-ME-TF8-NT4	1/2	1/4	1.42	0.56	0.86	0.90	0.28	13/16	7/8	1.02	1.11
SS-ME-TF8-NT6	1/2	3/8	1.42	0.56	0.86	0.90	0.38	13/16	7/8	1.02	1.11
SS-ME-TF8-NT8	1/2	1/2	1.42	0.75	0.86	0.90	0.41	13/16	7/8	1.02	1.30
SS-ME-TF8-NT12	1/2	3/4	1.57	0.75	0.86	0.90	0.41	1-1/16	7/8	1.17	1.45
SS-ME-TF10-NT6	5/8*	3/8	1.50	0.56	0.86	0.96	0.38	15/16	1	1.10	1.19
SS-ME-TF10-NT8	5/8*	1/2	1.50	0.75	0.86	0.96	0.47	15/16	1	1.10	1.38
SS-ME-TF10-NT12	5/8*	3/4	1.57	0.75	0.86	0.96	0.50	1-1/16	1	1.17	1.45
SS-ME-TF12-NT8	3/4	1/2	1.57	0.75	0.86	0.96	0.47	1-1/16	1-1/8	1.17	1.45
SS-ME-TF12-NT12	3/4	3/4	1.57	0.75	0.86	0.96	0.62	1-1/16	1-1/8	1.17	1.45
SS-ME-TF16-NT12	1	3/4	1.93	0.75	1.04	1.23	0.62	1-3/8	1-1/2	1.45	1.64
SS-ME-TF16-NT16	1	1	1.93	0.75	1.04	1.23	0.88	1-3/8	1-1/2	1.45	1.83

Model Number	T Tube O.D. in.	P Tapered Pipe Thread (ISO PT)	A in.	B in.	C in.	D in.	E in.	F Hex Flat in.	G Hex Flat in.	Hx in.	Hy in.
SS-ME-TF2-RT2	1/8	1/8	0.93	0.38	0.60	0.50	0.09	7/16	7/16	0.67	0.70
SS-ME-TF2-RT4	1/8	1/4	0.97	0.56	0.60	0.50	0.09	1/2	7/16	0.71	0.92
SS-ME-TF4-RT2	1/4	1/8	1.06	0.38	0.70	0.60	0.19	1/2	9/16	0.77	0.74
SS-ME-TF4-RT4	1/4	1/4	1.06	0.56	0.70	0.60	0.19	1/2	9/16	0.77	0.92
SS-ME-TF4-RT6	1/4	3/8	1.17	0.56	0.70	0.60	0.19	11/16	9/16	0.88	1.03
SS-ME-TF6-RT4	3/8	1/4	1.20	0.56	0.76	0.66	0.28	5/8	11/16	0.91	1.00
SS-ME-TF6-RT6	3/8	3/8	1.23	0.56	0.76	0.66	0.28	11/16	11/16	0.94	1.03
SS-ME-TF8-RT6	1/2	3/8	1.42	0.56	0.86	0.90	0.38	13/16	7/8	1.02	1.11
SS-ME-TF8-RT8	1/2	1/2	1.42	0.75	0.86	0.90	0.41	13/16	7/8	1.02	1.30
SS-ME-TF12-RT12	3/4	3/4	1.57	0.75	0.86	0.96	0.62	1-1/16	1-1/8	1.17	1.45

*: Consult factory

Male Elbows

METRIC UNITS

Model Number	T Tube O.D. mm	P NPT Male Pipe Size in.	A mm	B mm	C mm	D mm	E mm	F Hex Flat mm	G Hex Flat mm	Hx mm	Hy mm
SS-ME-TF3M-NT2	3	1/8	23.6	9.70	15.3	12.9	2.4	11.1	12	17.0	17.8
SS-ME-TF3M-NT4	3	1/4	24.6	14.2	15.3	12.9	2.4	16.0	12	18.0	23.4
SS-ME-TF6M-NT2	6	1/8	27.0	9.70	17.7	15.3	4.8	12.7	14	19.6	18.8
SS-ME-TF6M-NT4	6	1/4	27.0	14.2	17.7	15.3	4.8	16.0	14	19.6	23.4
SS-ME-TF6M-NT6	6	3/8	29.8	14.2	17.7	15.3	4.8	20.5	14	22.4	26.2
SS-ME-TF6M-NT8	6	1/2	31.8	19.0	17.7	15.3	4.8	23.8	14	24.4	33.0
SS-ME-TF8M-NT2	8	1/8	28.8	9.70	18.6	16.2	4.8	16.0	16	21.3	19.8
SS-ME-TF8M-NT4	8	1/4	28.8	14.2	18.6	16.2	6.4	16.0	16	21.3	24.4
SS-ME-TF8M-NT6	8	3/8	30.6	14.2	18.6	16.2	6.4	20.5	16	23.1	26.2
SS-ME-TF8M-NT8	8	1/2	32.6	19.0	18.6	16.2	6.4	23.8	16	25.1	33.0
SS-ME-TF10M-NT2	10	1/8	31.5	9.70	19.5	17.2	4.8	16.0	19	23.9	21.6
SS-ME-TF10M-NT4	10	1/4	31.5	14.2	19.5	17.2	7.1	16.0	19	23.9	26.2
SS-ME-TF10M-NT6	10	3/8	31.5	14.2	19.5	17.2	7.9	20.5	19	23.9	26.2
SS-ME-TF10M-NT8	10	1/2	33.5	19.0	19.5	17.2	7.9	23.8	19	25.9	33.0
SS-ME-TF12M-NT4	12	1/4	36.0	14.2	22.0	22.8	7.1	20.5	22	25.9	28.2
SS-ME-TF12M-NT6	12	3/8	36.0	14.2	22.0	22.8	9.5	20.5	22	25.9	28.2
SS-ME-TF12M-NT8	12	1/2	36.0	19.0	22.0	22.8	9.5	23.8	22	25.9	33.0
SS-ME-TF12M-NT12	12	3/4	39.8	19.0	22.0	22.8	9.5	28.6	22	29.7	36.8
SS-ME-TF16M-NT6	16*	3/8	38.0	14.2	22.0	24.4	9.5	23.8	25	27.9	30.2
SS-ME-TF16M-NT8	16*	1/2	38.0	19.0	22.0	24.4	11.9	23.8	25	27.9	35.1
SS-ME-TF16M-NT12	16*	3/4	39.8	19.0	22.0	24.4	12.7	27	25	29.7	36.8
SS-ME-TF18M-NT8	18*	1/2	39.8	19.0	22.0	24.4	11.9	27	30	29.7	36.8
SS-ME-TF18M-NT12	18*	3/4	39.8	19.0	22.0	24.4	15.1	27	30	29.7	36.8
SS-ME-TF22M-NT12	22*	3/4	44.6	19.0	22.0	26.0	15.9	35	32	34.5	41.7
SS-ME-TF22M-NT16	22*	1	44.6	23.9	22.0	26.0	18.3	35	32	34.5	46.5
SS-ME-TF25M-NT12	25*	3/4	49.1	19.0	26.5	31.3	15.9	35	38	36.8	41.7
SS-ME-TF25M-NT16	25*	1	49.1	23.9	26.5	31.3	21.8	35	38	36.8	46.5

Model Number	T Tube O.D. mm	P Tapered Pipe Thread (ISO PT)	A mm	B mm	C mm	D mm	E mm	F Hex Flat mm	G Hex Flat mm	Hx mm	Hy mm
SS-ME-TF3M-RT2	3	1/8	23.6	9.70	15.3	12.9	2.4	11.1	12	17.0	17.8
SS-ME-TF6M-RT4	6	1/4	27.0	14.2	17.7	15.3	4.8	16.0	14	19.6	23.4
SS-ME-TF6M-RT6	6	3/8	29.8	14.2	17.7	15.3	4.8	20.5	14	22.4	26.2
SS-ME-TF8M-RT8	8	1/2	32.6	19.0	18.6	16.2	6.4	23.8	16	25.1	33.0

*: Consult factory