

Male Connectors

GENLOK to Male NPT Thread

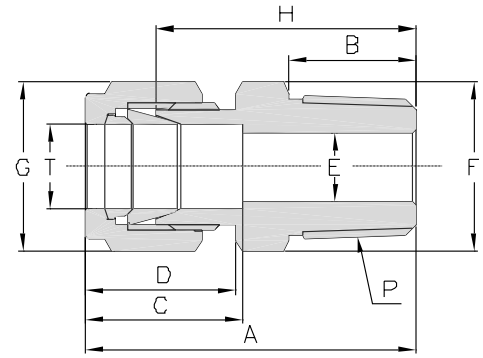

ENGLISH UNITS

Model Number	T Tube O.D. in.	P NPT Male Pipe Size in.	A in.	B in.	C in.	D in.	E in.	F Hex Flat in.	G Hex Flat in.	H in.
SS-MC-TF2-NT2	1/8	1/8	1.20	0.38	0.60	0.50	0.09	7/16	7/16	0.94
SS-MC-TF2-NT4	1/8	1/4	1.40	0.56	0.60	0.50	0.09	9/16	7/16	1.14
SS-MC-TF3-NT2	3/16*	1/8	1.23	0.38	0.63	0.54	0.12	7/16	1/2	0.97
SS-MC-TF3-NT4	3/16*	1/4	1.43	0.56	0.63	0.54	0.12	9/16	1/2	1.17
SS-MC-TF4-NT2	1/4	1/8	1.29	0.38	0.70	0.60	0.19	1/2	9/16	1.00
SS-MC-TF4-NT4	1/4	1/4	1.49	0.56	0.70	0.60	0.19	9/16	9/16	1.20
SS-MC-TF4-NT6	1/4	3/8	1.51	0.56	0.70	0.60	0.19	11/16	9/16	1.22
SS-MC-TF4-NT8	1/4	1/2	1.76	0.75	0.70	0.60	0.19	7/8	9/16	1.47
SS-MC-TF5-NT2	5/16*	1/8	1.34	0.38	0.73	0.64	0.19	9/16	5/8	1.05
SS-MC-TF5-NT4	5/16*	1/4	1.52	0.56	0.73	0.64	0.25	9/16	5/8	1.23
SS-MC-TF6-NT2	3/8	1/8	1.39	0.38	0.76	0.66	0.19	5/8	11/16	1.10
SS-MC-TF6-NT4	3/8	1/4	1.57	0.56	0.76	0.66	0.28	5/8	11/16	1.28
SS-MC-TF6-NT6	3/8	3/8	1.57	0.56	0.76	0.66	0.28	11/16	11/16	1.28
SS-MC-TF6-NT8	3/8	1/2	1.82	0.75	0.76	0.66	0.28	7/8	11/16	1.53
SS-MC-TF6-NT12	3/8	3/4	1.88	0.75	0.76	0.66	0.28	1-1/16	11/16	1.59
SS-MC-TF8-NT2	1/2	1/8	1.53	0.38	0.86	0.90	0.19	13/16	7/8	1.13
SS-MC-TF8-NT4	1/2	1/4	1.71	0.56	0.86	0.90	0.28	13/16	7/8	1.31
SS-MC-TF8-NT6	1/2	3/8	1.71	0.56	0.86	0.90	0.38	13/16	7/8	1.31
SS-MC-TF8-NT8	1/2	1/2	1.93	0.75	0.86	0.90	0.41	7/8	7/8	1.53
SS-MC-TF8-NT12	1/2	3/4	1.99	0.75	0.86	0.90	0.41	1-1/16	7/8	1.59
SS-MC-TF8-NT16	1/2	1	2.25	0.94	0.86	0.90	0.41	1-3/8	7/8	1.85
SS-MC-TF10-NT6	5/8*	3/8	1.74	0.56	0.86	0.96	0.38	15/16	1	1.34
SS-MC-TF10-NT8	5/8*	1/2	1.93	0.75	0.86	0.96	0.47	15/16	1	1.53
SS-MC-TF10-NT12	5/8*	3/4	1.99	0.75	0.86	0.96	0.50	1-1/16	1	1.59
SS-MC-TF12-NT8	3/4	1/2	1.99	0.75	0.86	0.96	0.47	1-1/16	1-1/8	1.59
SS-MC-TF12-NT12	3/4	3/4	1.99	0.75	0.86	0.96	0.62	1-1/16	1-1/8	1.59
SS-MC-TF12-NT16	3/4	1	2.25	0.94	0.86	0.96	0.62	1-3/8	1-1/8	1.85
SS-MC-TF16-NT12	1	3/4	2.26	0.75	1.04	1.23	0.62	1-3/8	1-1/2	1.78
SS-MC-TF16-NT16	1	1	2.45	0.94	1.04	1.23	0.88	1-3/8	1-1/2	1.97

Model Number	T Tube O.D. in.	P Tapered Pipe Thread (ISO PT)	A in.	B in.	C in.	D in.	E in.	F Hex Flat in.	G Hex Flat in.	H in.
SS-MC-TF2-RT2	1/8	1/8	1.20	0.38	0.60	0.50	0.09	7/16	7/16	0.94
SS-MC-TF2-RT4	1/8	1/4	1.40	0.56	0.60	0.50	0.09	9/16	7/16	1.14
SS-MC-TF4-RT2	1/4	1/8	1.29	0.38	0.70	0.60	0.19	1/2	9/16	1.00
SS-MC-TF4-RT4	1/4	1/4	1.49	0.56	0.70	0.60	0.19	9/16	9/16	1.20
SS-MC-TF4-RT6	1/4	3/8	1.51	0.56	0.70	0.60	0.19	11/16	9/16	1.22
SS-MC-TF6-RT4	3/8	1/4	1.57	0.56	0.76	0.66	0.28	5/8	11/16	1.28
SS-MC-TF6-RT6	3/8	3/8	1.57	0.56	0.76	0.66	0.28	11/16	11/16	1.28
SS-MC-TF8-RT8	1/2	1/2	1.93	0.75	0.86	0.90	0.41	7/8	7/8	1.53
SS-MC-TF12-RT12	3/4	3/4	1.99	0.75	0.86	0.96	0.62	1-1/16	1-1/8	1.59

*: Consult factory

Male Connectors

METRIC UNITS

Model Number	T Tube O.D. mm	P NPT Male Pipe Size in.	A mm	B mm	C mm	D mm	E mm	F Hex Flat mm	G Hex Flat mm	H mm
SS-MC-TF3M-NT2	3	1/8	30.5	9.70	15.3	12.9	2.4	12	12	23.9
SS-MC-TF3M-NT4	3	1/4	35.6	14.2	15.3	12.9	2.4	14	12	29.0
SS-MC-TF6M-NT2	6	1/8	32.8	9.70	17.7	15.3	4.8	14	14	25.4
SS-MC-TF6M-NT4	6	1/4	37.9	14.2	17.7	15.3	4.8	14	14	30.5
SS-MC-TF6M-NT6	6	3/8	38.4	14.2	17.7	15.3	4.8	18	14	31.0
SS-MC-TF6M-NT8	6	1/2	44.7	19.0	17.7	15.3	4.8	22	14	37.3
SS-MC-TF8M-NT2	8	1/8	34.2	9.70	18.6	16.2	4.8	15	16	26.7
SS-MC-TF8M-NT4	8	1/4	38.7	14.2	18.6	16.2	6.4	15	16	31.2
SS-MC-TF8M-NT6	8	3/8	39.3	14.2	18.6	16.2	6.4	18	16	31.8
SS-MC-TF8M-NT8	8	1/2	45.6	19.0	18.6	16.2	6.4	22	16	38.1
SS-MC-TF10M-NT2	10	1/8	36.3	9.70	19.5	17.2	4.8	18	19	28.7
SS-MC-TF10M-NT4	10	1/4	40.9	14.2	19.5	17.2	7.9	18	19	33.3
SS-MC-TF10M-NT6	10	3/8	40.9	14.2	19.5	17.2	7.9	18	19	33.3
SS-MC-TF10M-NT8	10	1/2	46.5	19.0	19.5	17.2	7.9	22	19	38.9
SS-MC-TF10M-NT12	10	3/4	48.0	19.0	19.5	17.2	7.9	27	19	40.4
SS-MC-TF12M-NT2	12	1/8	38.8	9.70	22.0	22.8	4.8	22	22	28.7
SS-MC-TF12M-NT4	12	1/4	43.4	14.2	22.0	22.8	7.1	22	22	33.3
SS-MC-TF12M-NT6	12	3/8	43.4	14.2	22.0	22.8	9.5	22	22	33.3
SS-MC-TF12M-NT8	12	1/2	49.0	19.0	22.0	22.8	9.5	22	22	38.9
SS-MC-TF12M-NT12	12	3/4	50.5	19.0	22.0	22.8	9.5	27	22	40.4
SS-MC-TF14M-NT4	14	1/4	44.1	14.2	22.0	24.4	7.1	24	25	34.0
SS-MC-TF14M-NT6	14	3/8	44.1	14.2	22.0	24.4	9.5	24	25	34.0
SS-MC-TF14M-NT8	14	1/2	49.0	19.0	22.0	24.4	11.1	24	25	38.0
SS-MC-TF16M-NT6	16*	3/8	44.1	14.2	22.0	24.4	9.5	24	25	34.0
SS-MC-TF16M-NT8	16*	1/2	49.0	19.0	22.0	24.4	11.9	24	25	38.9
SS-MC-TF16M-NT12	16*	3/4	50.5	19.0	22.0	24.4	12.7	27	25	40.4
SS-MC-TF18M-NT8	18*	1/2	50.5	19.0	22.0	24.4	11.9	27	30	40.4
SS-MC-TF18M-NT12	18*	3/4	50.5	19.0	22.0	24.4	15.1	27	30	40.4
SS-MC-TF22M-NT12	22*	3/4	52.3	19.0	22.0	26.0	15.9	30	32	42.2
SS-MC-TF22M-NT16	22*	1	57.1	23.9	22.0	26.0	18.3	35	32	47.0
SS-MC-TF25M-NT8	25*	1/2	57.5	19.0	26.5	31.3	11.9	35	38	45.2
SS-MC-TF25M-NT12	25*	3/4	57.5	19.0	26.5	31.3	15.9	35	38	45.2
SS-MC-TF25M-NT16	25*	1	62.3	23.9	26.5	31.3	21.8	35	38	50.0

Model Number	T Tube O.D. mm	P Tapered Pipe Thread (ISO PT)	A mm	B mm	C mm	D mm	E mm	F Hex Flat mm	G Hex Flat mm	H mm
SS-MC-TF3M-RT2	3	1/8	30.5	9.70	15.3	12.9	2.4	12	12	23.9
SS-MC-TF3M-RT4	3	1/4	35.6	14.2	15.3	12.9	2.4	14	12	29.0
SS-MC-TF6M-RT2	6	1/8	32.8	9.70	17.7	15.3	4.8	14	14	25.4
SS-MC-TF6M-RT4	6	1/4	37.9	14.2	17.7	15.3	4.8	14	14	30.5
SS-MC-TF6M-RT6	6	3/8	38.4	14.2	17.7	15.3	4.8	18	14	31.0
SS-MC-TF8M-RT6	8	3/8	39.3	14.2	18.6	16.2	6.4	18	16	31.8
SS-MC-TF8M-RT8	8	1/2	45.6	19.0	18.6	16.2	6.4	22	16	38.1

*: Consult factory