

Male Branch Tees

GENLOK to Male NPT Thread Branch

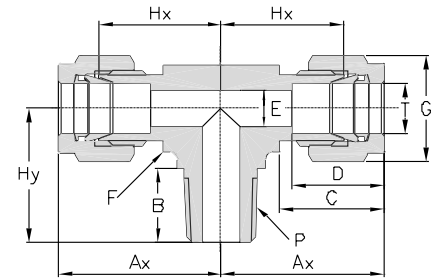

ENGLISH UNITS

Model Number	T Tube O.D. in.	P NPT Male Pipe Size in.	Ax in.	B in.	C in.	D in.	E in.	F Hex Flat in.	G Hex Flat in.	Hx in.	Hy in.
SS-MBT-TF2-NT2	1/8	1/8	0.93	0.38	0.60	0.50	0.09	7/16	7/16	0.67	0.70
SS-MBT-TF2-NT4	1/8	1/4	0.97	0.56	0.60	0.50	0.09	1/2	7/16	0.71	0.92
SS-MBT-TF3-NT2	3/16*	1/8	0.96	0.38	0.63	0.54	0.12	7/16	1/2	0.70	0.70
SS-MBT-TF4-NT2	1/4	1/8	1.06	0.38	0.70	0.60	0.19	1/2	9/16	0.77	0.74
SS-MBT-TF4-NT4	1/4	1/4	1.06	0.56	0.70	0.60	0.19	1/2	9/16	0.77	0.92
SS-MBT-TF5-NT2	5/16*	1/8	1.17	0.38	0.73	0.64	0.19	5/8	5/8	0.88	0.82
SS-MBT-TF6-NT4	3/8	1/4	1.20	0.56	0.76	0.66	0.28	5/8	11/16	0.91	1.00
SS-MBT-TF6-NT6	3/8	3/8	1.31	0.56	0.76	0.66	0.28	13/16	11/16	1.02	1.11
SS-MBT-TF8-NT6	1/2	3/8	1.42	0.56	0.86	0.90	0.38	13/16	7/8	1.02	1.11
SS-MBT-TF8-NT8	1/2	1/2	1.42	0.75	0.86	0.90	0.41	13/16	7/8	1.02	1.30
SS-MBT-TF10-NT8	5/8*	1/2	1.53	0.75	0.86	0.96	0.47	1	1	1.13	1.41
SS-MBT-TF12-NT12	3/4	3/4	1.57	0.75	0.86	0.96	0.62	1-1/16	1-1/8	1.17	1.45

Model Number	T Tube O.D. in.	Tx Tapered Pipe Thread (ISO PT)	Ax in.	B in.	C in.	D in.	E in.	F Hex Flat in.	G Hex Flat in.	Hx in.	Hy in.
SS-MBT-TF2-RT2	1/8	1/8	0.93	0.38	0.60	0.50	0.09	7/16	7/16	0.67	0.70
SS-MBT-TF2-RT4	1/8	1/4	0.97	0.56	0.60	0.50	0.09	1/2	7/16	0.71	0.92
SS-MBT-TF4-RT2	1/4	1/8	1.06	0.38	0.70	0.60	0.19	1/2	9/16	0.77	0.74
SS-MBT-TF4-RT4	1/4	1/4	1.06	0.56	0.70	0.60	0.19	1/2	9/16	0.77	0.92
SS-MBT-TF6-RT4	3/8	1/4	1.20	0.56	0.76	0.66	0.28	5/8	11/16	0.91	1.00
SS-MBT-TF6-RT6	3/8	3/8	1.31	0.56	0.76	0.66	0.28	13/16	11/16	1.02	1.11
SS-MBT-TF8-RT8	1/2	1/2	1.42	0.75	0.86	0.90	0.41	13/16	7/8	1.02	1.30
SS-MBT-TF12-RT12	3/4	3/4	1.57	0.75	0.86	0.96	0.62	1-1/16	1-1/8	1.17	1.45

*: Consult factory

Male Branch Tees

METRIC UNITS

Model Number	T Tube O.D. mm	P NPT Male Pipe Size in.	Ax mm	B mm	C mm	D mm	E mm	F Hex Flat mm	G Hex Flat mm	Hx mm	Hy mm
SS-MBT-TF6M-NT2	6	1/8	27.0	9.70	17.7	15.3	4.8	12.7	14	19.6	18.8
SS-MBT-TF6M-NT4	6	1/4	27.0	14.2	17.7	15.3	4.8	16.0	14	19.6	23.4
SS-MBT-TF8M-NT2	8	1/8	29.9	9.70	18.6	16.2	4.8	16.0	16	22.4	20.8
SS-MBT-TF8M-NT4	8	1/4	29.9	14.2	18.6	16.2	6.4	16.0	16	22.4	25.4
SS-MBT-TF10M-NT4	10	1/4	33.5	14.2	19.5	17.2	7.1	20.5	19	25.9	28.2
SS-MBT-TF12M-NT4	12	1/4	36.0	14.2	22.0	22.8	7.1	20.5	22	25.9	28.2
SS-MBT-TF12M-NT6	12	3/8	36.0	14.2	22.0	22.8	9.5	20.5	22	25.9	28.2
SS-MBT-TF12M-NT8	12	1/2	36.0	19.0	22.0	22.8	9.5	23.8	22	25.9	33.0

Model Number	T Tube O.D. mm	Tx Tapered Pipe Thread (ISO PT)	Ax mm	B mm	C mm	D mm	E mm	F Hex Flat mm	G Hex Flat mm	Hx mm	Hy mm
SS-MBT-TF6M-RT4	6	1/4	27.0	14.2	17.7	15.3	4.8	16.0	14	19.6	23.4
SS-MBT-TF8M-RT4	8	1/4	29.9	14.2	18.6	16.2	6.4	16.0	16	22.4	25.4
SS-MBT-TF12M-RT6	12	3/8	36.0	14.2	22.0	22.8	9.5	20.5	22	25.9	28.2