

## Male Adapters

Tube to Male NPT Thread

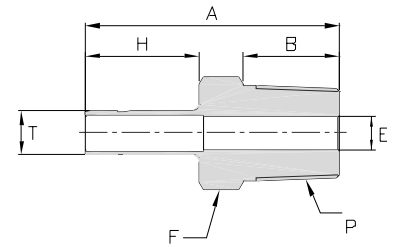
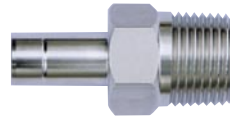

### ENGLISH UNITS

Model Number	T Tube O.D. in.	P NPT Male Pipe Size in.	A in.	B in.	E in.	F Hex Flat in.	H in.
SS-MA-OD2-NT2	1/8	1/8	1.16	0.38	0.08	7/16	0.53
SS-MA-OD2-NT4	1/8	1/4	1.37	0.56	0.08	9/16	0.53
SS-MA-OD3-NT2	3/16*	1/8	1.19	0.38	0.12	7/16	0.56
SS-MA-OD3-NT4	3/16*	1/4	1.40	0.56	0.12	9/16	0.56
SS-MA-OD4-NT2	1/4	1/8	1.25	0.38	0.17	7/16	0.62
SS-MA-OD4-NT4	1/4	1/4	1.46	0.56	0.17	9/16	0.62
SS-MA-OD4-NT6	1/4	3/8	1.49	0.56	0.17	11/16	0.62
SS-MA-OD4-NT8	1/4	1/2	1.71	0.75	0.17	7/8	0.62
SS-MA-OD5-NT2	5/16*	1/8	1.29	0.38	0.19	7/16	0.65
SS-MA-OD5-NT4	5/16*	1/4	1.50	0.56	0.22	9/16	0.65
SS-MA-OD6-NT2	3/8	1/8	1.32	0.38	0.19	7/16	0.68
SS-MA-OD6-NT4	3/8	1/4	1.53	0.56	0.27	9/16	0.68
SS-MA-OD6-NT6	3/8	3/8	1.56	0.56	0.27	11/16	0.68
SS-MA-OD6-NT8	3/8	1/2	1.78	0.75	0.27	7/8	0.68
SS-MA-OD8-NT4	1/2	1/4	1.75	0.56	0.28	9/16	0.90
SS-MA-OD8-NT6	1/2	3/8	1.78	0.56	0.37	11/16	0.90
SS-MA-OD8-NT8	1/2	1/2	2.00	0.75	0.37	7/8	0.90
SS-MA-OD10-NT6	5/8*	3/8	1.81	0.56	0.47	11/16	0.96
SS-MA-OD10-NT8	5/8*	1/2	2.06	0.75	0.47	7/8	0.96
SS-MA-OD10-NT12	5/8*	3/4	2.03	0.75	0.50	1-1/16	0.96
SS-MA-OD12-NT8	3/4	1/2	2.06	0.75	0.47	7/8	0.96
SS-MA-OD12-NT12	3/4	3/4	2.06	0.75	0.58	1-1/16	0.96
SS-MA-OD12-NT16	3/4	1	2.28	0.94	0.58	1-3/8	0.96
SS-MA-OD16-NT12	1	3/4	2.31	0.75	0.62	1-1/16	1.21
SS-MA-OD16-NT16	1	1	2.60	0.94	0.80	1-3/8	1.21

### METRIC UNITS

Model Number	T Tube O.D. mm	P NPT Male Pipe Size in.	A mm	B mm	E mm	F Hex Flat mm	H mm
SS-MA-OD6M-NT2	6	1/8	32.8	9.70	4.1	12	15.7
SS-MA-OD6M-NT4	6	1/4	38.1	14.2	4.1	14	15.7
SS-MA-OD8M-NT4	8	1/4	39.1	14.2	5.6	14	16.5
SS-MA-OD10M-NT4	10	1/4	39.9	14.2	7.1	14	17.3
SS-MA-OD10M-NT6	10	3/8	40.6	14.2	7.1	18	17.3
SS-MA-OD10M-NT8	10	1/2	46.2	19.1	7.1	22	17.3
SS-MA-OD12M-NT4	12	1/4	46.5	14.2	7.1	16	22.9
SS-MA-OD12M-NT8	12	1/2	52.1	19.1	8.8	22	22.9

\*: Consult factory