

■ Caps

Caps

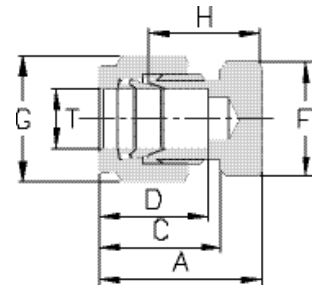

ENGLISH UNITS

Model Number	T Tube O.D. in.	A in.	C in.	D in.	F Hex Flat in.	G Hex Flat in.	H in.
SS-C-TF2	1/8	0.79	0.60	0.50	7/16	7/16	0.53
SS-C-TF3	3/16*	0.84	0.63	0.54	7/16	1/2	0.58
SS-C-TF4	1/4	0.92	0.70	0.60	1/2	9/16	0.62
SS-C-TF5	5/16*	0.96	0.73	0.64	9/16	5/8	0.67
SS-C-TF6	3/8	1.01	0.76	0.66	5/8	11/16	0.72
SS-C-TF8	1/2	1.15	0.86	0.90	13/16	7/8	0.75
SS-C-TF10	5/8*	1.18	0.86	0.96	15/16	1	0.78
SS-C-TF12	3/4	1.24	0.86	0.96	1-1/16	1-1/8	0.84
SS-C-TF16	1	1.51	1.04	1.23	1-3/8	1-1/2	1.03

METRIC UNITS

Model Number	T Tube O.D. mm	A mm	C mm	D mm	F Hex Flat mm	G Hex Flat mm	H mm
SS-C-TF3M	3	20.1	15.3	12.9	12	12	13.5
SS-C-TF6M	6	23.1	17.7	15.3	14	14	15.7
SS-C-TF8M	8	24.5	18.6	16.2	15	16	17.0
SS-C-TF10M	10	26.6	19.5	17.2	18	19	19.0
SS-C-TF12M	12	29.1	22.0	22.8	22	22	19.0

*: Consult factory

■ Nuts

Nuts

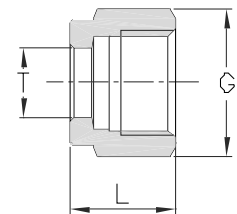

ENGLISH UNITS

Model Number	T Tube O.D. in.	G Hex Flat in.	L in.
SS-N-TF2	1/8	7/16	0.47
SS-N-TF3	3/16*	1/2	0.47
SS-N-TF4	1/4	9/16	0.50
SS-N-TF5	5/16*	5/8	0.53
SS-N-TF6	3/8	11/16	0.56
SS-N-TF8	1/2	7/8	0.69
SS-N-TF10	5/8*	1	0.69
SS-N-TF12	3/4	1-1/8	0.69
SS-N-TF16	1	1-1/2	0.81

METRIC UNITS

Model Number	T Tube O.D. mm	G Hex Flat mm	L mm
SS-N-TF3M	3	12	11.9
SS-N-TF6M	6	14	12.7
SS-N-TF8M	8	16	13.5
SS-N-TF10M	10	19	15.1
SS-N-TF12M	12	22	17.4

*: Consult factory