

**300A AIR COOLED MIG WELDING TORCH**

Rating:300A CO<sup>2</sup> 270A mixed gas EN60974-7 @ 60% duty cycle. 0.8 to 1.2mm wires<sup>1</sup>

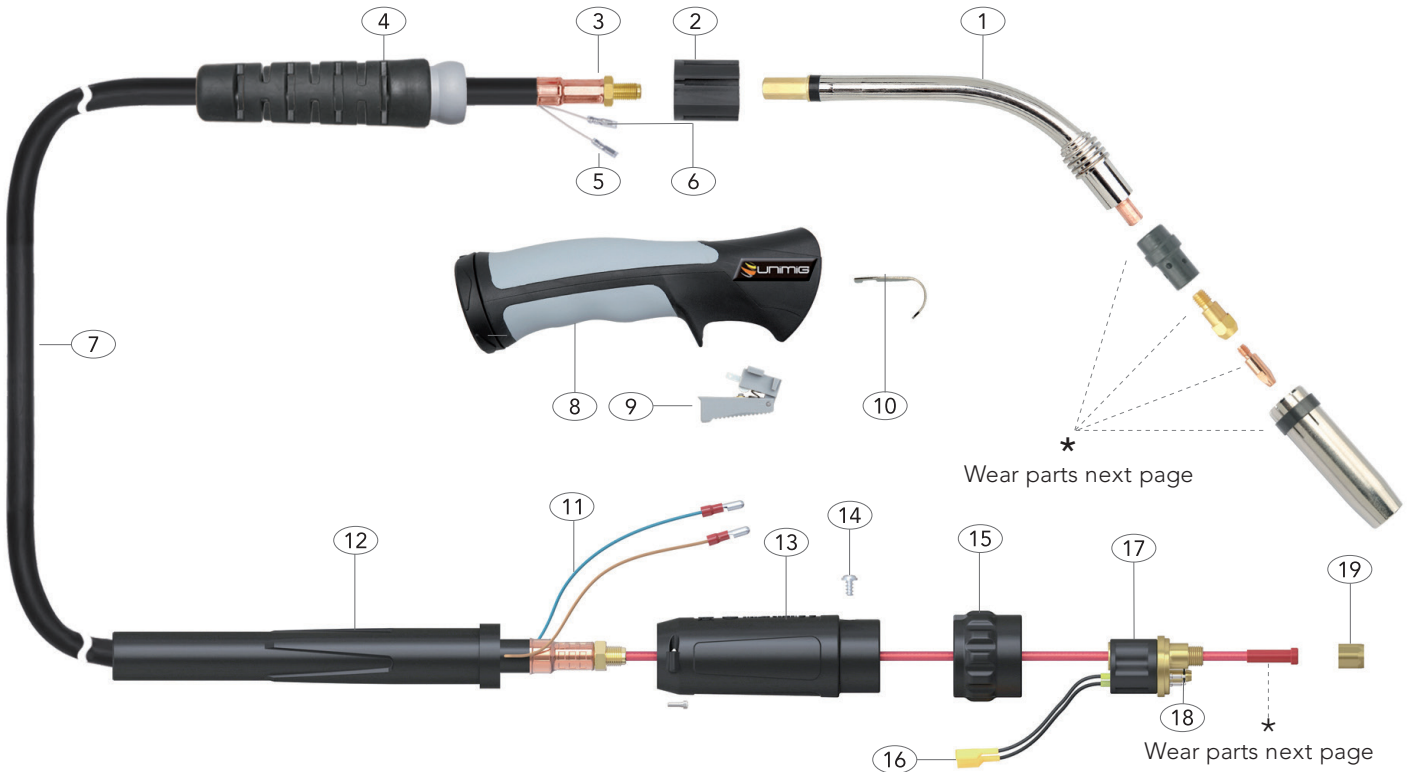

Torch Model			
Description	Part Number	4 Mt	5 Mt
SB36 Suregrip Ergo Torch Package	SB36-3M	SB36-4M	SB36-5M

Spare Parts				
Part Number	Description	Part Number	Description	
1	SNK36	9	UG2516	Medium / Large Ergo Trigger
2	UG1515	10	UB2517	Hanger Hook
3	UB1505	11	UB1522	Cable Terminal Male
4	UG8016	12	UC8026	Housing Spring
5	UB1521	13	UB1518L	Gun Plug Housing C/W Nut
6	UB1521-C	14	UB1526	Gun Plug Screw
7	UB3609-30	15	UB1519/S	Gun Plug Nut
	UB3609-40	16	UB1523	Gun Plug Terminal Female
	UB3609-50	17	UB1528	Gun Plug Body C/W Spring Pins
8	8UG2514	18	UB1524	Gun Plug 'O' Ring
		19	UB1525	Liner Nut

These parts are manufactured in China and are offered as replacement parts suitable for "BINZEL®" style torches.

# Suregrip Series

## SB36 MIG TORCH



### Front end consumables

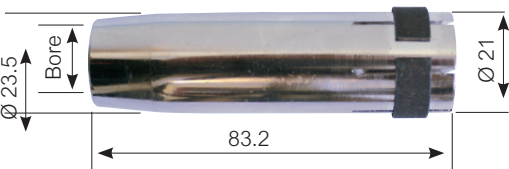
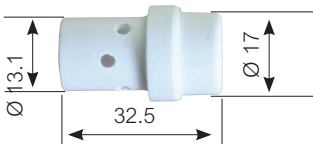
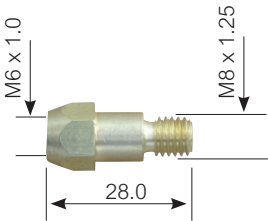
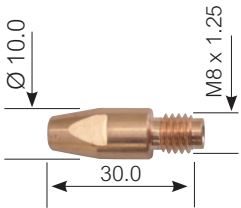
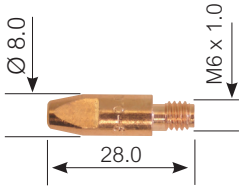

### Liners

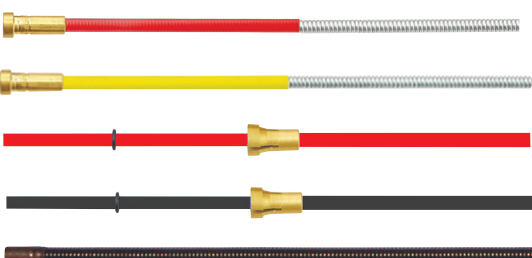

### SB36 Contact Tips M6

Part Number	Description	QTY
PCT0009-06	Contact Tip Steel (0.6mm)	QTY10
PCT0009-08	Contact Tip Steel (0.8mm)	QTY10
PCT0009-09	Contact Tip Steel (0.9mm)	QTY10
PCT0009-10	Contact Tip Steel (1.0mm)	QTY10
PCT0009-12	Contact Tip Steel (1.2mm)	QTY10
PCT0009-16	Contact Tip Steel (1.6mm)	QTY10
PCTZR009-09	Contact Tip Steel Long Life (0.9mm)	QTY10
PCTZR009-12	Contact Tip Steel Long Life (1.2mm)	QTY10
PCTAL0009-09	Contact Tip Aluminium (0.9mm)	QTY10
PCTAL0009-10	Contact Tip Aluminium (1.0mm)	QTY10
PCTAL0009-12	Contact Tip Aluminium (1.2mm)	QTY10
PCT0005-08	Contact Tip Steel M8 (0.8mm)	QTY10
PCT0005-09	Contact Tip Steel M8 (0.9mm)	QTY10
PCT0005-10	Contact Tip Steel M8 (1.0mm)	QTY10
PCT0005-12	Contact Tip Steel M8 (1.2mm)	QTY10
PCT0005-16	Contact Tip Steel M8 (1.6mm)	QTY10
PCTAL0005-08	Contact Tip Aluminium M8 (0.8mm)	QTY10
PCTAL0005-09	Contact Tip Aluminium M8 (0.9mm)	QTY10
PCTAL0005-10	Contact Tip Aluminium M8 (1.0mm)	QTY10
PCTAL0005-12	Contact Tip Aluminium M8 (1.2mm)	QTY10
PCTAL0005-16	Contact Tip Aluminium M8 (1.6mm)	QTY10

### SB36 Tip Holder M8

Part Number	Description	QTY
PCTH36M6S	Contact Tip Holder M6 (Short)	QTY2
PCTH36M8S	Contact Tip Holder M8 (Short)	QTY2

### SB36 Tip Holder M6

Part Number	Description	QTY
PCTH36M6L	Contact Tip Holder M6 (Long)	QTY2
PCTH36M8L	Contact Tip Holder M8 (Long)	QTY2

### SB36 Gas Diffuser

Part Number	Description	QTY
PCGD36	Gas Diffuser	QTY2

### SB36 Gas Nozzle

Part Number	Description	QTY
PGN36CYL	Cylindrical Nozzle	QTY2
PGN36CON	Conical Nozzle	QTY2
PGN36TAP	Tapered Nozzle	QTY2

### SB36 Liners

Part Number	Description	QTY
SLB3M	Blue Steel Liner 3 Metre	} 0.6 - 0.8mm
SLB4M	Blue Steel Liner 4 Metre	
SLB5M	Blue Steel Liner 5 Metre	
SLR3M	Red Steel Liner 3 Metre	} 0.9 - 1.2mm
SLR4M	Red Steel Liner 4 Metre	
SLR5M	Red Steel Liner 5 Metre	
SLY3M	Yellow Steel Liner 3 Metre	} 1.2 - 1.6mm
SLY4M	Yellow Steel Liner 4 Metre	
SLY5M	Yellow Steel Liner 5 Metre	
TLB3M	Blue Aluminium Liner 3 Metre	} 0.6 - 0.8mm
TLB4M	Blue Aluminium Liner 4 Metre	
TLR3M	Red Aluminium Liner 3 Metre	} 0.9 - 1.2mm
TLR4M	Red Aluminium Liner 4 Metre	
TLY3M	Yellow Aluminium Liner 3 Metre	} 1.2 - 1.6mm
TLY4M	Yellow Aluminium Liner 4 Metre	
NKSTL	Neck Spring for Aluminium	