

Suregrip Series

SB25 MIG TORCH



230A AIR COOLED MIG WELDING TORCH

Rating: 230A CO₂ 200A mixed gas EN60974-7 @ 60% duty cycle. 0.8 to 1.2mm wires

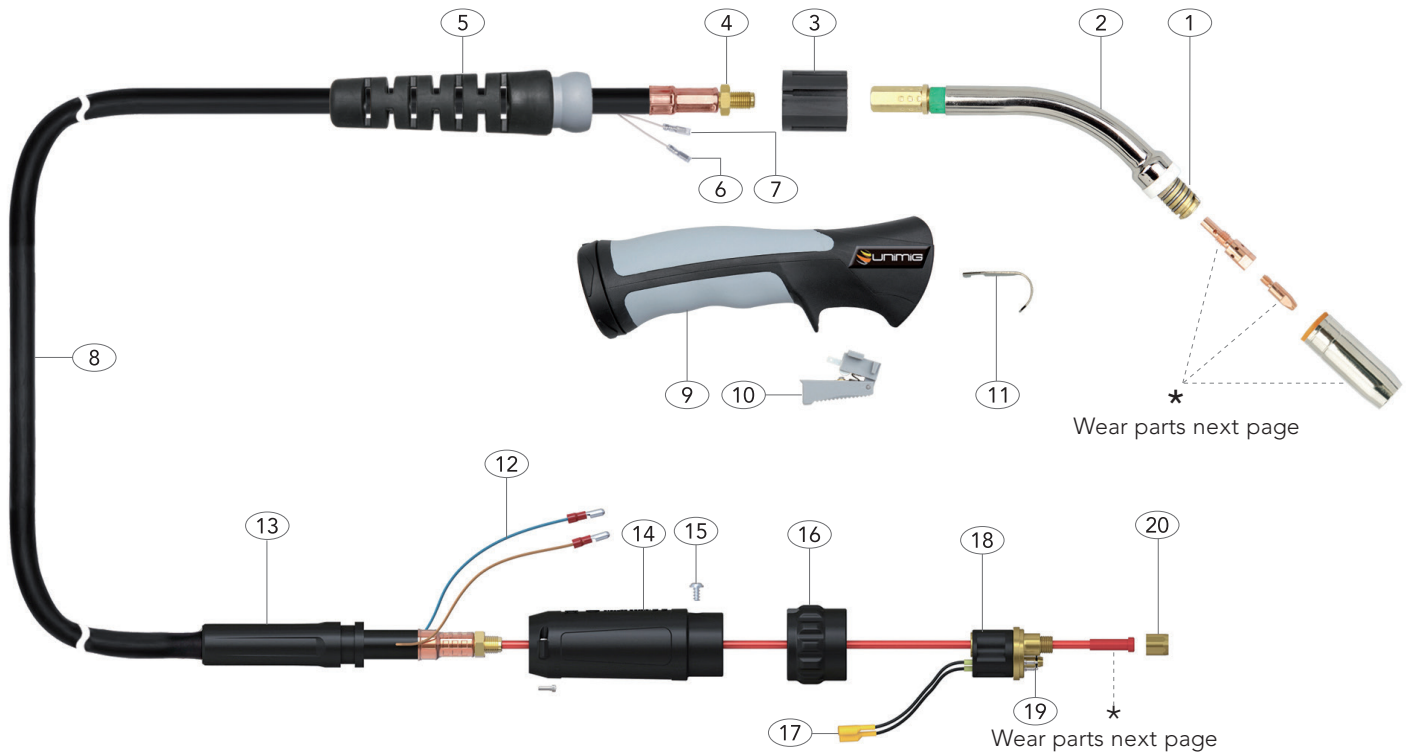

Torch Model			
Description	Part Number	4 Mt	5 Mt
	3 Mt		
SB25 Suregrip Ergo Torch Package	SB25-3M	SB25-4M	SB25-5M

Spare Parts			
Part Number	Description	Part Number	Description
1	GNS25 Shroud Spring	10	UG2516 Medium / Large Ergo Trigger
2	SNK25 Swan Neck Assembly	11	UB2517 Hanger Hook
	SNKF Swan Neck Flexible Assembly	12	UB1522 Cable Terminal Male
3	UG1515 Ergo Handle Location Body	13	UPA2041 Cable Support
4	UB1505 Lock Nut	14	UB1518 Gun Plug Housing C/W Nut
5	UG8015 Handle Cable Support C/W Ball Joint	15	UB1541 Gun Plug Screw
6	UB1521 Cable Terminal	16	UB1519/S Gun Plug Nut
7	UB1521-C Cable Terminal Cover	17	UB1523 Gun Plug Terminal Female
8	UB2503-30 Hyperflex Cable Assembly x 3mt	18	UC1528 Hybrid Gun Plug Body C/W Spring Pins
	UB2503-40 Hyperflex Cable Assembly x 4mt	19	UB1524 Gun Plug 'O' Ring
	UB2503-50 Hyperflex Cable Assembly x 5mt	20	UB1525 Liner Nut
9	UG2514 Ergo Handle Kit C/W Lock Nut		

Suregrip Series SB25 MIG TORCH



Front end consumables

SB25 Contact Tips

Part Number	Description	QTY
PCT0009-06	Contact Tip Steel (0.6mm)	QTY10
PCT0009-08	Contact Tip Steel (0.8mm)	QTY10
PCT0009-09	Contact Tip Steel (0.9mm)	QTY10
PCT0009-10	Contact Tip Steel (1.0mm)	QTY10
PCT0009-12	Contact Tip Steel (1.2mm)	QTY10
PCT0009-16	Contact Tip Steel (1.6mm)	QTY10
PCTZR009-09	Contact Tip Steel Long Life (0.9mm)	QTY10
PCTZR009-12	Contact Tip Steel Long Life (1.2mm)	QTY10
PCTAL0009-09	Contact Tip Aluminium (0.9mm)	QTY10
PCTAL0009-10	Contact Tip Aluminium (1.0mm)	QTY10
PCTAL0009-12	Contact Tip Aluminium (1.2mm)	QTY10

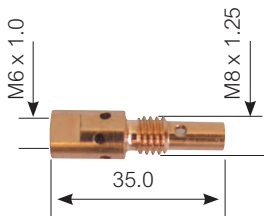
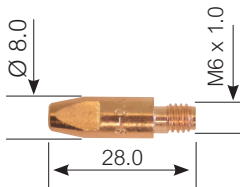

SB25 Tip Holder

Part Number	Description	QTY
PCTH25	Contact Tip Holder	QTY2
PGNS25	Shroud Spring	QTY2

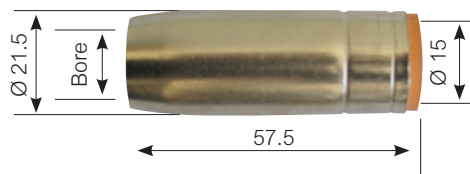

SB25 Gas Nozzle

Part Number	Description	QTY
PGN25CYL	Cylindrical Nozzle	QTY2
PGN25CON	Conical Nozzle	QTY2
PGN25TAP	Tapered Nozzle	QTY2
PGN25SPOT	Spot Nozzle	QTY2

Liners

SB25 Liners

Part Number	Description	QTY
SLB3M	Blue Steel Liner 3 Metre	} 0.6 - 0.8mm
SLB4M	Blue Steel Liner 4 Metre	
SLB5M	Blue Steel Liner 5 Metre	
SLR3M	Red Steel Liner 3 Metre	} 0.9 - 1.2mm
SLR4M	Red Steel Liner 4 Metre	
SLR5M	Red Steel Liner 5 Metre	
TLB3M	Blue Aluminium Liner 3 Metre	} 0.6 - 0.8mm
TLB4M	Blue Aluminium Liner 4 Metre	
TLR3M	Red Aluminium Liner 3 Metre	} 0.9 - 1.2mm
TLR4M	Red Aluminium Liner 4 Metre	
TLY3M	Yellow Aluminium Liner 3 Metre	} 1.2 - 1.6mm
TLY4M	Yellow Aluminium Liner 4 Metre	
NKSTL	Neck Spring for Aluminium	

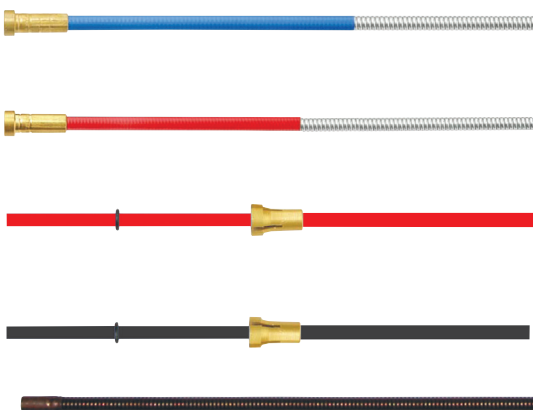

These parts are manufactured in China and are offered as replacement parts suitable for "BINZEL®" style torches.