

# Suregrip Series

## SB15 MIG TORCH



### 180A AIR COOLED MIG WELDING TORCH

Rating: 180A CO<sub>2</sub> 150A mixed gas EN60974-7 @ 60% duty cycle. 0.6 to 1.0mm wires

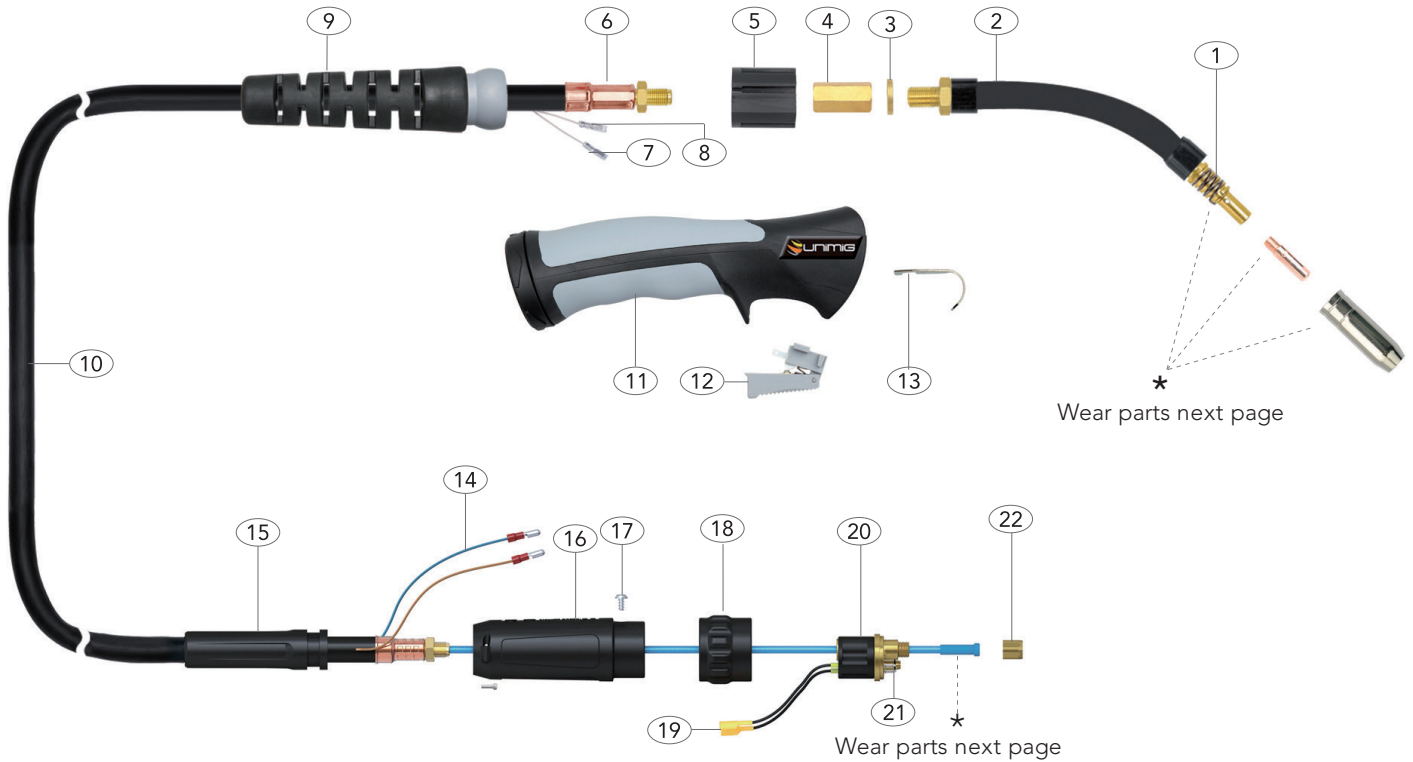

Torch Model			
Description	Part Number		
	3 Mt	4 Mt	5 Mt
SB Suregrip Ergo Torch Package	SB15-3M	SB15-4M	SB15-5M

Spare Parts					
Part Number	Description	Part Number	Description	Part Number	Description
1	GNS15	Shroud Spring	11	UG2514	Ergo Handle Kit C/W Lock Nut
2	SNK15	Swan Neck Assembly	12	UG2516	Medium / Large Ergo Trigger
	SNKF15	Flexible Swan Neck	13	UB2517	Hanger Hook
3	UB2501/5	End Fitting Ring	14	UB1522	Cable Terminal Male
4	UB2519	Hexagonal Fitting	15	UPA2041	Cable Support
5	UG1515	Ergo Handle Location Body	16	UB1518	Gun Plug Housing C/W Nut
6	UB1505	Lock Nut	17	UB1541	Gun Plug Screw
7	UB1521	Cable Terminal	18	UB1519PL	Gun Plug Nut
8	UB1521-C	Cable Terminal Cover	19	UB1523	Gun Plug Terminal Female
9	UG8015	Handle Cable Support C/W Ball Joint	20	UC1528	Hybrid Gun Plug Body C/W Spring Pins
10	UB1517-30	Hyperflex Cable Assembly x 3mt	21	UB1524	Gun Plug 'O' Ring
	UB1517-40	Hyperflex Cable Assembly x 4mt	22	UB1525	Liner Nut
	UB1517-50	Hyperflex Cable Assembly x 5mt			

# Suregrip Series SB15 MIG TORCH



## Front end consumables

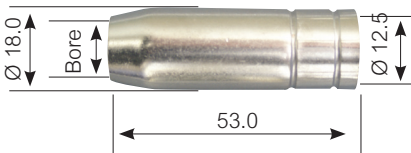
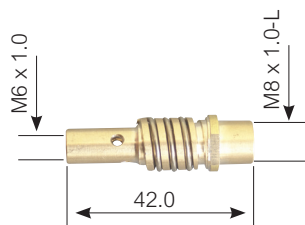
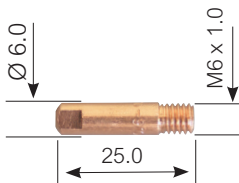

### SB15 Contact Tips

Part Number	Description	QTY
PCT0008-06	Contact Tip Steel (0.6mm)	QTY10
PCT0008-08	Contact Tip Steel (0.8mm)	QTY10
PCT0008-09	Contact Tip Steel (0.9mm)	QTY10
PCT0008-10	Contact Tip Steel (1.0mm)	QTY10
PCTAL0008-09	Contact Tip Aluminium (0.9mm)	QTY10
PCTAL0008-10	Contact Tip Aluminium (1.0mm)	QTY10

### SB15 Tip Holder

Part Number	Description	QTY
PCTH15	Contact Tip Holder (Suit SB15)	QTY2
PGNS15	Shroud Spring	QTY2

### SB15 Gas Nozzle

Part Number	Description	QTY
PGN15CYL	Cylindrical Nozzle	QTY2
PGN15CON	Conical Nozzle	QTY2
PGN15TAP	Tapered Nozzle	QTY2
PGN15SPOT	Spot Nozzle	QTY2

## Liners

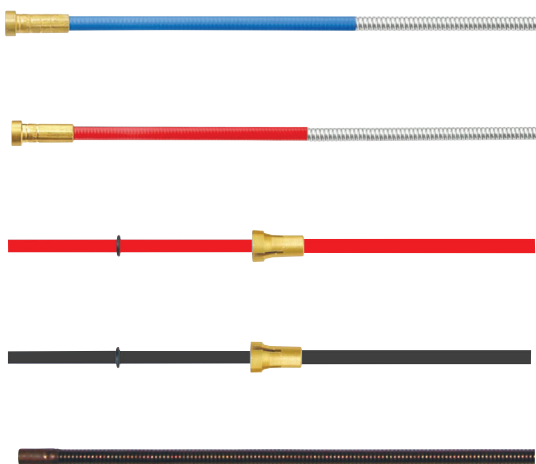

### SB15 Liners

Part Number	Description	QTY
SLB3M	Blue Steel Liner 3 Metre	} 0.6 - 0.8mm
SLB4M	Blue Steel Liner 4 Metre	
SLB5M	Blue Steel Liner 5 Metre	
SLR3M	Red Steel Liner 3 Metre	} 0.9 - 1.2mm
SLR4M	Red Steel Liner 4 Metre	
SLR5M	Red Steel Liner 5 Metre	
TLB3M	Blue Aluminium Liner 3 Metre	} 0.6 - 0.8mm
TLB4M	Blue Aluminium Liner 4 Metre	
TLR3M	Red Aluminium Liner 3 Metre	} 0.9 - 1.2mm
TLR4M	Red Aluminium Liner 4 Metre	
NKSTL	Neck Spring for Aluminium	

These parts are manufactured in China and are offered as replacement parts suitable for "BINZEL®" style torches.