

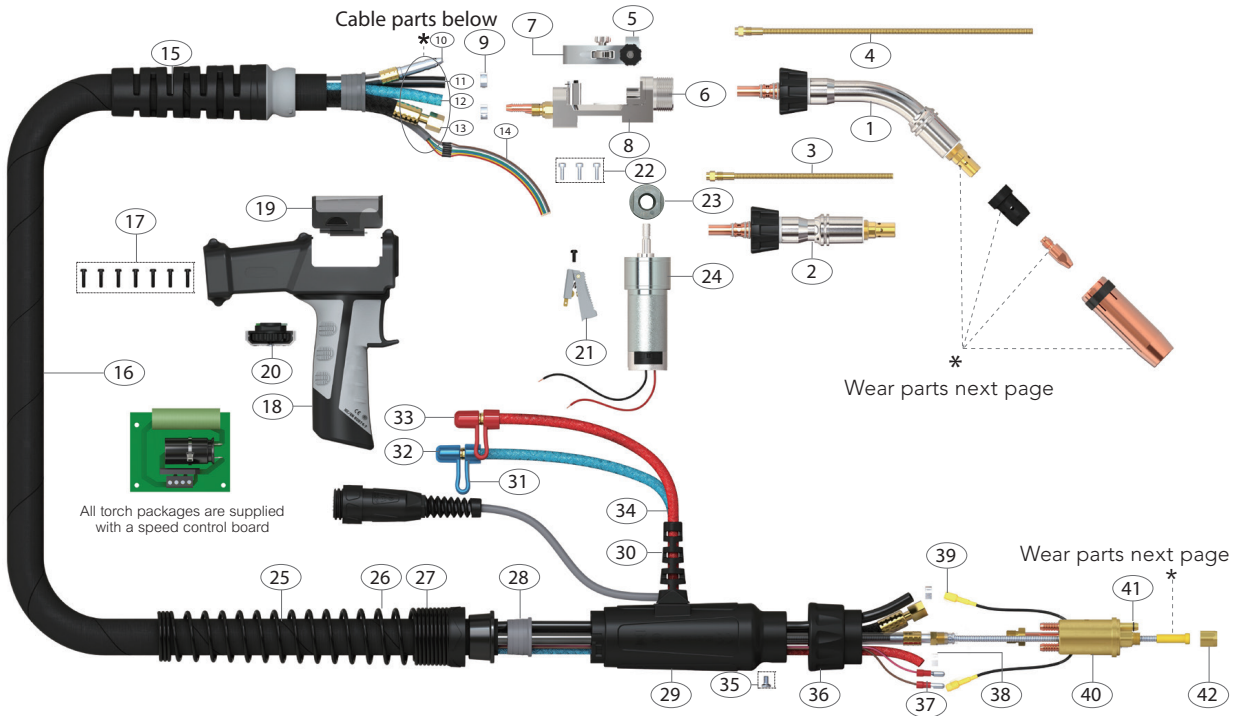

400A Water-Cooled MIG Welding Torch

Rating: 400A CO2 350A mixed gas, EN60974-7 @ 100% duty cycle. 1.0 to 1.6mm wires



Torch Model

Description

Part Number
8Mt

400 PUSH PULL WATERCOOLED MIG TORCH

PPLUWC40-42V-8M (includes PCB)

Spare Parts

Part Number	Description	Part Number	Description
1	UGP4011 Swan Neck Assembly 45	25	UC8027 Housing Spring
2	UGP4011A Straight Neck Assembly	26	UT8028 Spring Cable Support Nut
3	UGP4002 Jump Liner C/W Nipple	27	UT8009 Canvas Cover Clamp
4	UGP4002A Jump Liner C/W Nipple	28	UT8010 Canvas Cover Retainer
5	UGP36402 Pressure Arm Assembly	29	UT5022 Gun Plug Housing Assembly
6	UGP36402B Tension Knob	30	USLH1820-S Inlet/Outlet Hose Support
7	UGP36402R Pressure Roll	31	UB5023 Water Hose Nipple
8	UGP40101 Motor Body	32	UBD-80310 Blue Cap Stopper
9	UB5041 Water Hose Clamp 8.7MM	33	UBD-80320 Red Cap Stopper
15	UG3208 Handle Cable Support	34	US5017 Water Outlet Hose O/braid Rubber
16	UGP36419-80 Canvas Cover Assembly	35	UB1526 Gun Plug Screw
17	UCSP1 Handle Screw	36	UB1519/S Gun Plug Nut
18	UGP2514/KJ Push Pull Handle	37	UB1522 Cable Terminal Male
19	UGP2514/C Push Pull Handle Cover	38	UB5024 Water Hose Clamp 9.5MM
20	UGP0807-1 Potentiometer Kit 1K	39	UB1523 Gun Plug Terminal Female
	UGP0807-5 Potentiometer Kit 5K	40	UB5098 Gun Plug Body C/W Spring Pins
	UGP0807-10 Potentiometer Kit 10K	41	UB1524 Gun Plug 'O' Ring
	UGP0807-25 Potentiometer Kit 25K	42	UB1525 Liner Nut
21	UGP2516 Trigger		
22	UGPMS1 Motor Screw		
23	UGP8224W-08 Drive Roll For Wire 0.8		
	UGP8224W-09 Drive Roll For Wire 0.9		
	UGP8224W-10 Drive Roll For Wire 1.0		
	UGP8224W-16 Drive Roll For Wire 1.6		
	* UGP8224W-12 Drive Roll For Wire 1.2		
24	UGP8224-24 Motor 24V DC		
	UGP8224-42 Motor 42V DC		



Cable Parts

Description	Part Number
	8M
10 Outer Liner Assembly	UGP36408-80
11 Gas Hose Assembly	UGP36413-80
12 Water Inlet Hose Assembly	UGP40112-80
13 Power Cable Assembly	UGP40115-80
14 Switch Lead Assembly	UGP36410-80



Front end consumables

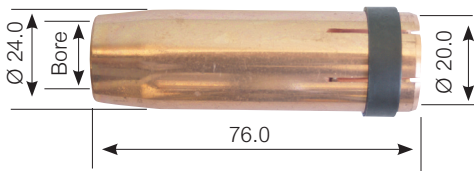
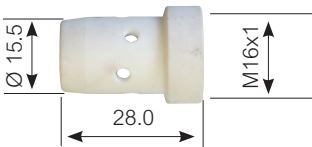
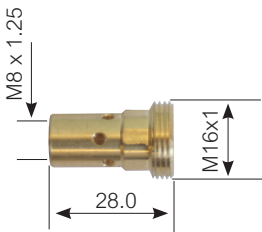
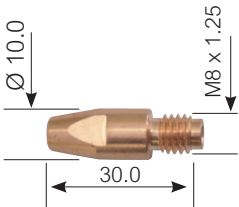

SGPPLW400 Contact Tips M8

Part Number	Description	
PCT0005-08	Contact tip M8 Steel Wire (0.8mm)	QTY10
PCT0005-09	Contact tip M8 Steel Wire (0.9mm)	QTY10
PCT0005-10	Contact tip M8 Steel Wire (1.0mm)	QTY10
PCT0005-12	Contact tip M8 Steel Wire (1.2mm)	QTY10
PCT0005-16	Contact tip M8 Steel Wire (1.6mm)	QTY10
PCTAL0005-09	Contact tip M8 Alloy Wire (0.9mm)	QTY10
PCTAL0005-10	Contact tip M8 Alloy Wire (1.0mm)	QTY10
PCTAL0005-12	Contact tip M8 Alloy Wire (1.2mm)	QTY10
PCTAL0005-16	Contact tip M8 Alloy Wire (1.6mm)	QTY10

SGPPLW400 Tip Holder

Part Number	Description	
PCTH500	Tip Holder M8 SB500	QTY2

SGPPLW400 Gas Diffuser

Part Number	Description	
PCGD38	Gas Diffuser (Suit SB38)	QTY2

SGPPLW400 Gas Nozzle

Part Number	Description	
PGN38CON	Gas Nozzle Conical	QTY2
PGN38CYL	Gas Nozzle Cylindrical	QTY2
PGN38TAP	Gas Nozzle Tapped	QTY2

Liners

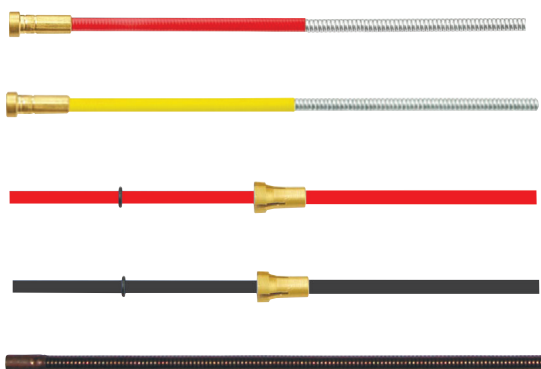

SGPPLW400 Liners

Part Number	Description	
PB5033-80B	Steel Liner 8 Metre	1.0 - 1.2mm
PB2513-80	Red Plastic Liner 8 Metre	0.9 - 1.2mm
PB5034-80B	Steel Liner 8 Metre	1.2 - 1.6mm
PB3626-80	Yellow Plastic Liner 8 Metre	1.2 - 1.6mm
NKSTL	Neck Spring for Aluminium	

These parts are manufactured in China and are offered as replacement parts suitable for "BINZEL®" style torches.