

PLASMA CUTTING TORCHES

SC80 Plasma Torch & Spares

Air Cooled 80 Amp



Rating: 80A Air/N₂ Gas, @ 60% duty cycle.

For use on **RAZORCut 45 KUPJRRW45** & **RAZORCut 80 KUPJRRW80**

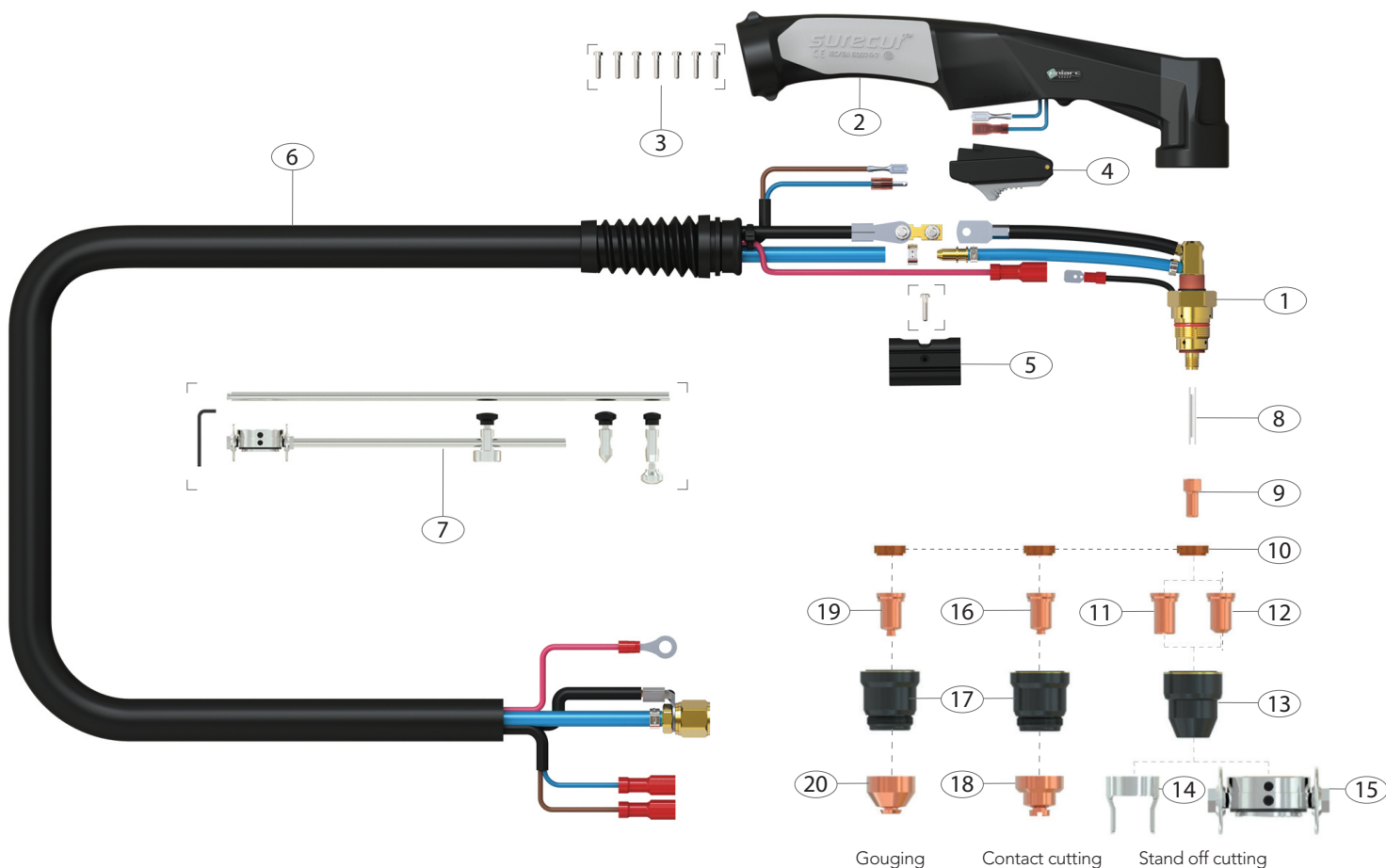

Torch Model	Description	Part Number
6 Mt	Surecut™ Plasma Cutting Torch Package	WG-SC80-60-CC1

Front end consumables

Torch Spare Parts			Wear Spare Parts		
No	WGA Part No.	Description	No	WGA Part No.	Description
1	SC8001	SC80 70 Torch Head Kit	8	SC8002	Cooling Tube
2	SC8014	Plasma Handle Kit	9	SC8004	Electrode
3	SCSP1	Screw Pack	10	SC8006	Swirl Ring
4	SC2516	Plasma Safety Trigger	11	SC8020-09	Cutting Tip 0.9mm
5	SC8015	Location Block	12	SC8020-10	Cutting Tip 1.0mm 40-50A
6	SC8019-60-CF4	Cable Assembly Complete X 6mt	13	SC8020-13	Cutting Tip 1.3mm 70-80A
7	SC8050	Circle Cutting Attachment Kit	14	SC8030	Retaining Cup
			15	SC8040	Stand Off Guide
			16	SC8051	Cutting Buggy
			17	SC8026-10	Cutting Tip Contact 1.0mm
			18	SC8026-11	Cutting Tip Contact 1.1mm
			19	SC8026-12	Cutting Tip Contact 1.2mm
			20	SC8026-13	Cutting Tip Contact 1.3mm
				SC8031	Shield Cap Body
				SC8041	Shield Cap
				SC8028-16	Gouging Tip 1.6mm
				SC8043	Shield Cap Gouging