

# Suregrip Series 17V TIG TORCH



## 150A AIR COOLED TIG WELDING TORCH

Rating: 150Amp DC, 105Amp AC @35% duty cycle.

For use with non gas solenoid machines

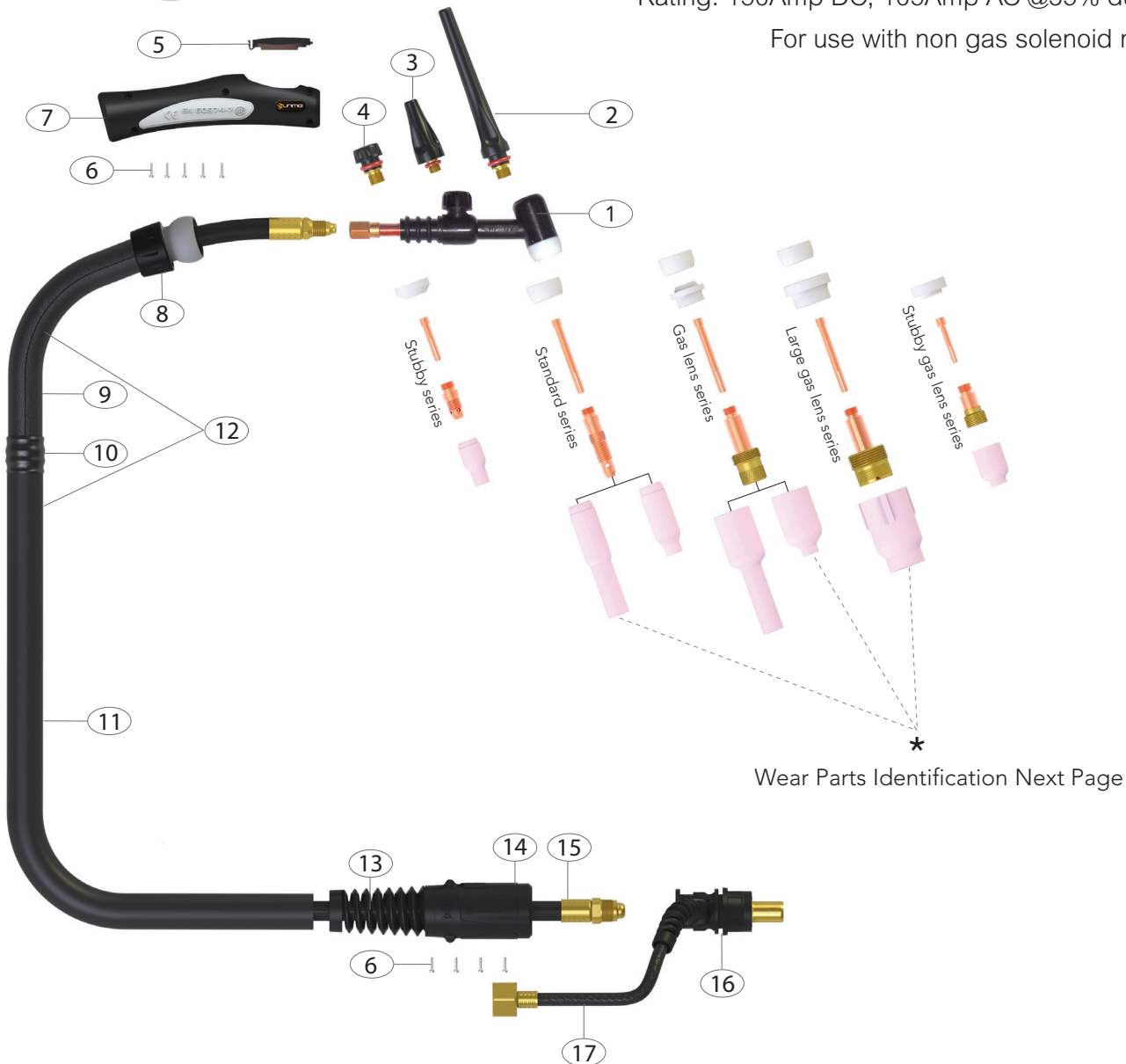

\*  
Wear Parts Identification Next Page

Torch Model	Description		Part Number	
			4m	8m
17V Suregrip Tig Torch Package c/w 2m Gas Hose			17V-4MCP25	17V-8MCP25
			17V-4MCP50	17V-8MCP50

Spare Parts		Part Number	Description		
1	WP17V	Torch head	11	UERNCL-32	Neoprene Cover X 3.2mt
	WP17VF	Torch head flexible	12	UERNCL-72	Neoprene Cover X 7.2mt
2	57Y02	Back cap long	12	UERCO100-40	Sheath X 12.5ft Inc Leather Cover
3	57Y03	Medium back cap	12	UERCO100-80	Sheath X 25ft Inc Leather Cover
4	57Y04	Short back cap	13	USLH917-S	Cable Support Small
5	UERBS	Blank Kitt	14	USLH917-H	"Surelok" Housing Small
6	UERSP1	Screw Pack	15	USL57Y01AR	"Power Cable X 12.5ft Surelok" Rubber
7	UERH100	Small Ergo Tig Handle	15	USL57Y03AR	Power Cable X 25ft Surelok Rubber
8	UERKJ100	Small Knuckle Joint	16	USL3550	"Surelok" Body & Support
9	UERLC200-08	Leather Cover X 0.8mt	17	USL-1-GS4	Gas Supply Hose
10	UERJK100	Jointing Repair Kit			

# Suregrip Series

## 17V TIG TORCH



### Standard Front End Parts

Part #	Description	Part #	Description	Part #	Description
18CG	Cup Gasket	10N30	Collet Body 1.0mm	10N49L	Long Alumina Nozzle Ø 8mm #5L
		10N31	Collet Body 1.6mm	53N48L	Long Alumina Nozzle Ø 10mm #6L
		10N32	Collet Body 2.4mm	53N47L	Long Alumina Nozzle Ø 11mm #7L
		10N28	Collet Body 3.2mm		
				10N50	Alumina Nozzle Ø 6mm #4
				10N49	Alumina Nozzle Ø 8mm #5
				10N48	Alumina Nozzle Ø 10mm #6
				10N47	Alumina Nozzle Ø 11mm #7
				10N46	Alumina Nozzle Ø 13mm #8
				10N45	Alumina Nozzle Ø 16mm #10
				10N44	Alumina Nozzle Ø 19mm #12

### Compact Gas Lens Front End Parts

Part #	Description	Part #	Description	Part #	Description
54N01	Gas Lens Gasket	45V25	Gas Lens Body 1.6mm	54N14	Gas lens ceramic 8.0mm
		45V26	Gas Lens Body 2.4mm	54N15	Gas lens ceramic 7.0mm
		45V27	Gas Lens Body 3.2mm	54N17	Gas lens ceramic 5.0mm

### TR0004-16



**RED**  
ANSI/AWS A5.12-98  
ISO 6848 WT20

**2% Thoriated:** Best stability at medium currents, good arc starts, medium tendency to spit, medium erosion rate. Commonly used for steel and stainless steel applications

1/16 x 7" (1.6mm x 175mm)  
3/32 x 7" (2.4mm x 175mm)  
1/8 x 7" (3.2mm x 175mm)

Part #	Description
TR0004-10	1.0mm x 175mm thoriated tungsten electrode 2%
TR0004-16	1.6mm x 175mm thoriated tungsten electrode 2%
TR0004-24	2.4mm x 175mm thoriated tungsten electrode 2%
TR0004-32	3.2mm x 175mm thoriated tungsten electrode 2%